

How to change a Server Management Password through the mobile app?

Effective password management is essential for ensuring the security and privacy of your online accounts. Strong, unique passwords help protect your sensitive information from cyber threats such as identity theft and data breaches.

Prerequisites :

You must have an Active Server. You can jump to the tutorial section if the above conditions are proper, Or first follow the links below to set up the prerequisites.

How to install a Server

Tutorial :

You can watch the Video or Continue reading the post.

<https://www.youtube.com/embed/nH8EEEnGbayc>

Follow the steps below for Password Management.

1: Once logged in, look for a "Server" and click on it.

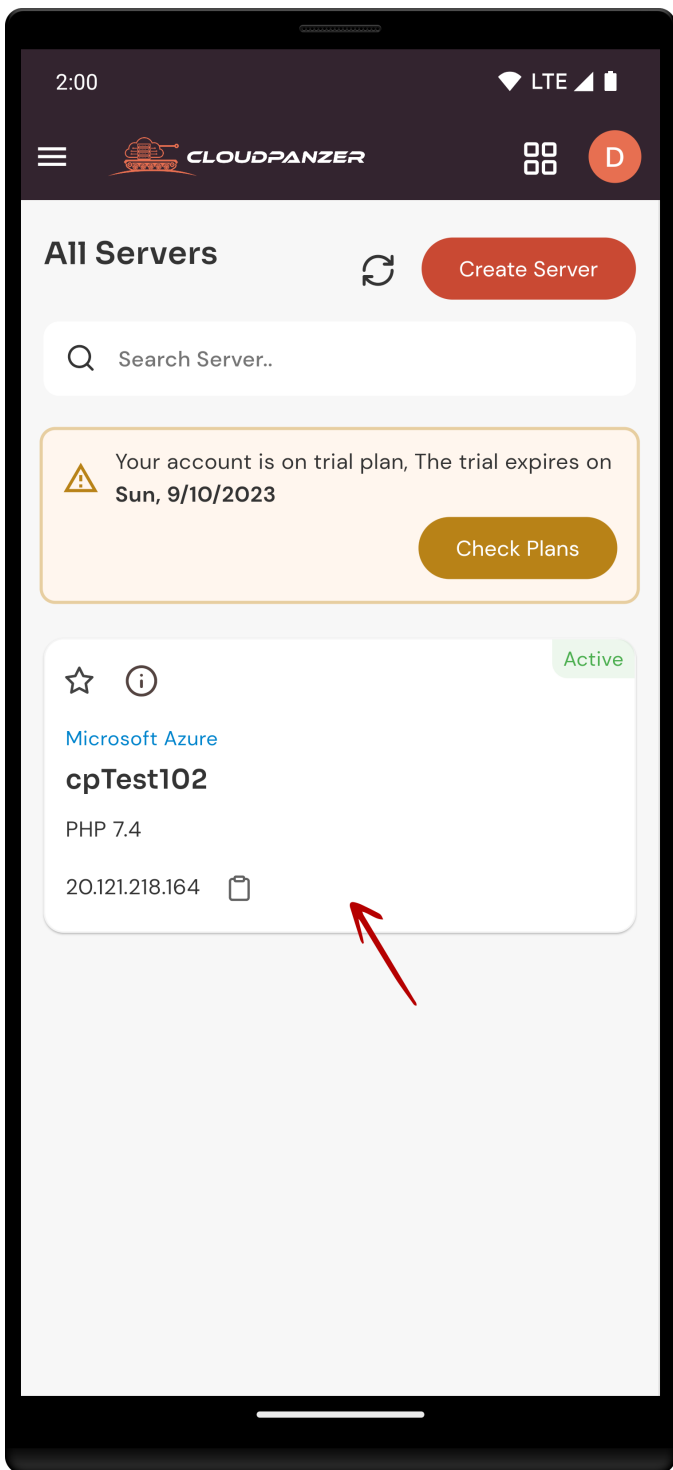

2. Select the Manage Password Option.

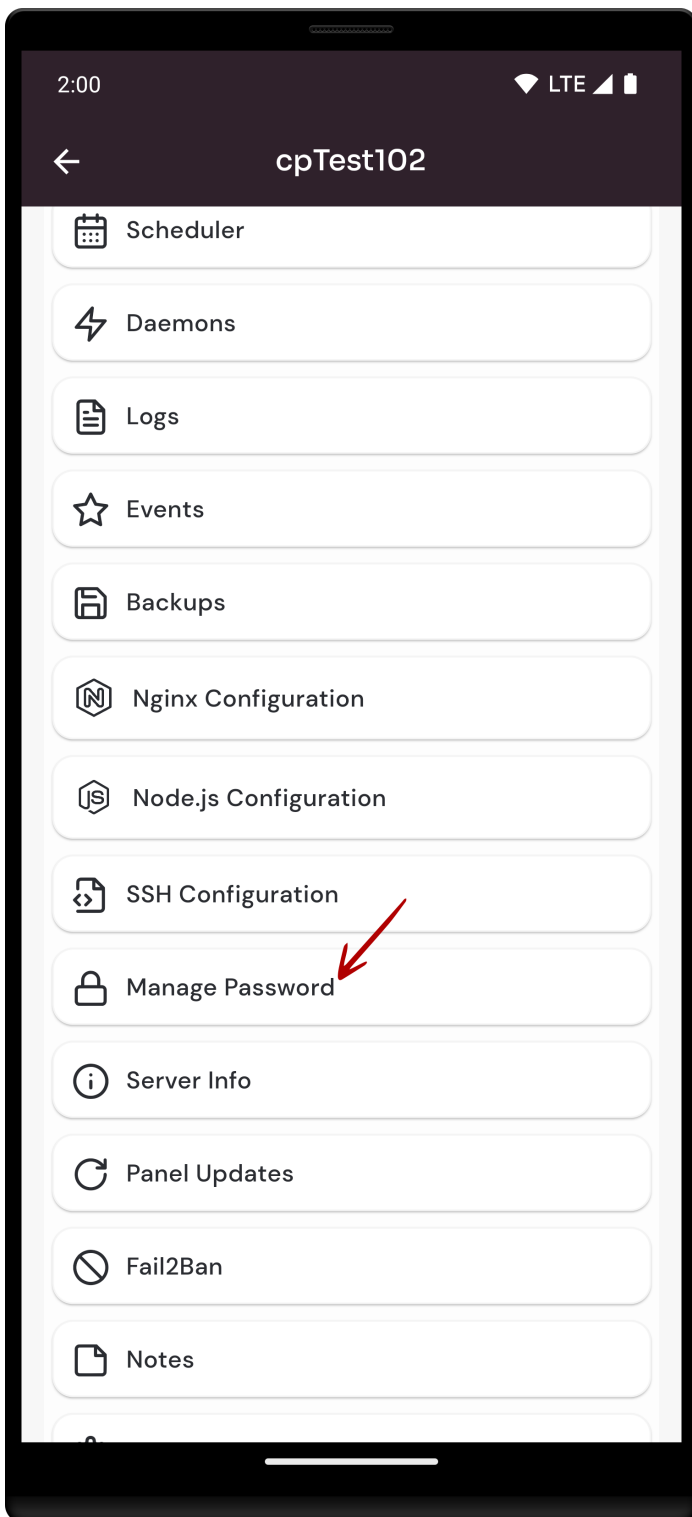

3. Click on the Generate Button and Update Button.

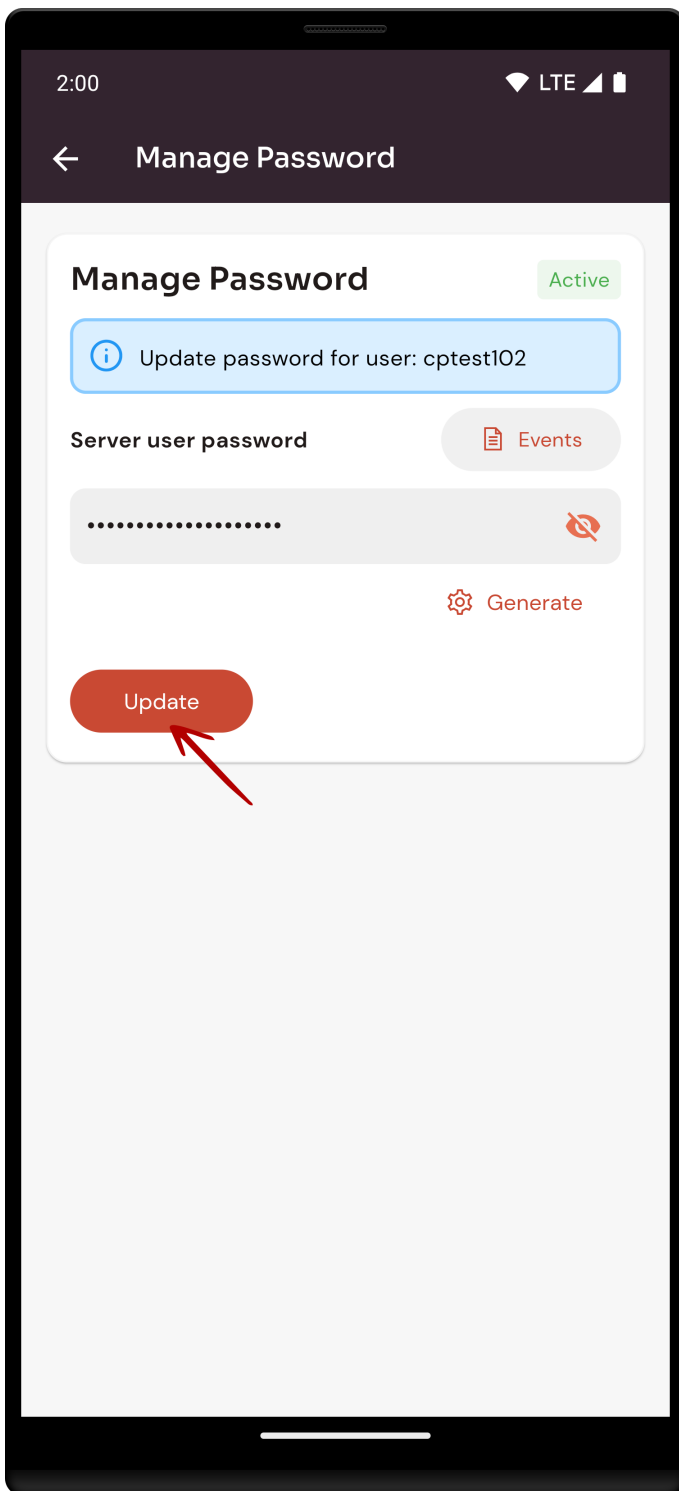

You can see that Password Management is successful.

2:00

LTE



Manage Password



Server user password updated
successfully

Manage Password

Active



Update password for user: cptest102



Save Password

Please store your password in a secure
place it will not be shown again.

Your Password

BTBPQ3HYMB9jSrYPM0q1

Server user password



Events

.....



Generate

Update



Looking for Web Instructions?

Available at <https://kb.cloudpanzer.com/books/web-portal/page/how-to-password-management>

Revision #11

Created 21 December 2022 11:28:02 by Admin

Updated 2 September 2023 07:13:58 by Admin